

Your Visit System

Baby - Cry Monitor TX - Description

Caring for your baby's health and safety is one of the most important things you do as a parent. Bellman & Symfon offers a fully secure baby monitoring solution for parents with hearing loss, so you are always close to your baby. The Visit baby monitor will notify you as soon as your baby needs you, even if you are asleep or a couple of rooms away.

FEATURES

Reliable transmission

Up to 250 m operating range

Flexible

Adjustable sensitivity and delay

Tamper resistant

To keep batteries out of child's reach

Optional contact mat

Know if your child leaves the bed

Easy to use

No complicated menus to navigate

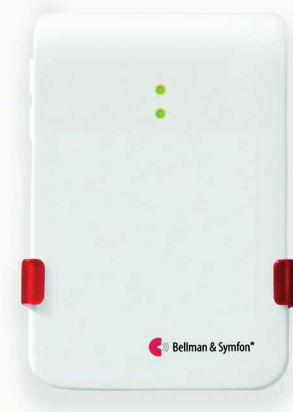

Buttons and connections

Test / settings

LED lights

3.5 mm ext. trig.

Microphone

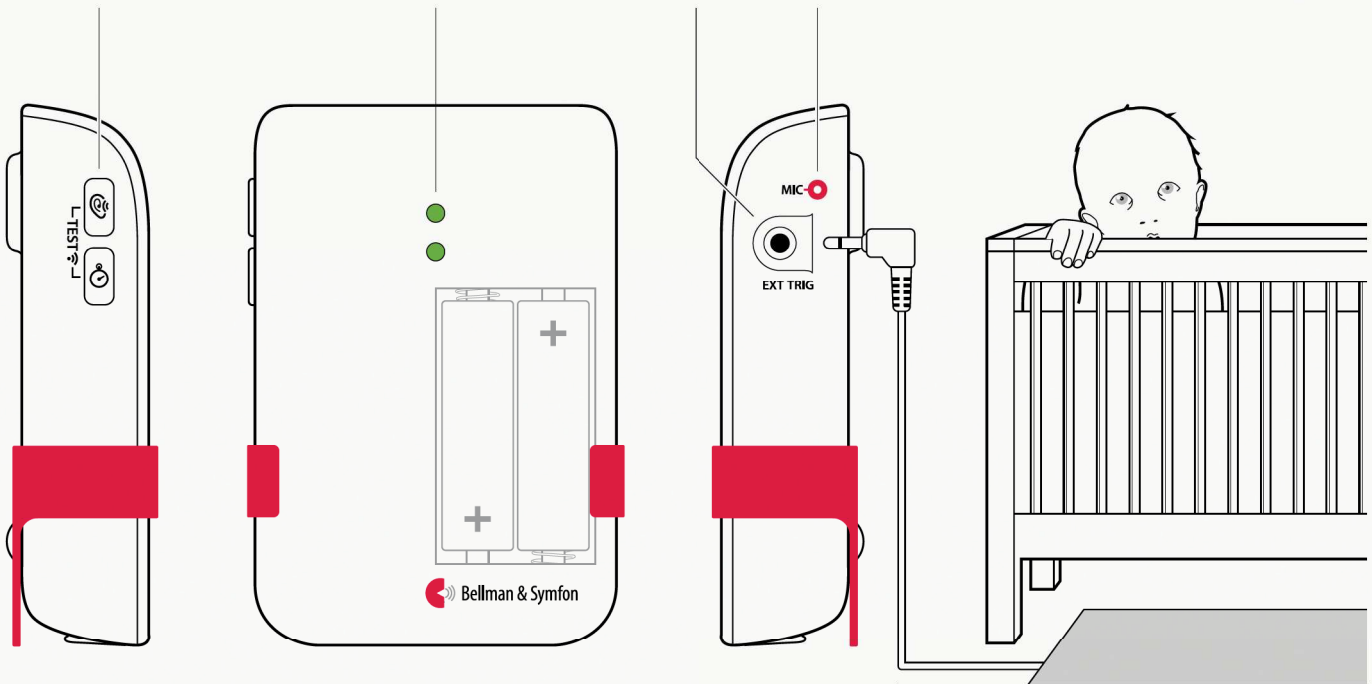

 Always make sure the baby monitor is out of the child's reach. Never place the baby monitor in the child's crib or playpen.

BE9026 contact mat